

# Stud Hole Fitting Flange Pro-Tectors

Suitable for ASA/ANSI/BS1560 flanges. Quick fitting  
 Simply insert plugs into the bolt holes  
 .1/2" – 150/300 lbs. to 12." – 150/300 lbs.

immediate

FREE SAMPLES

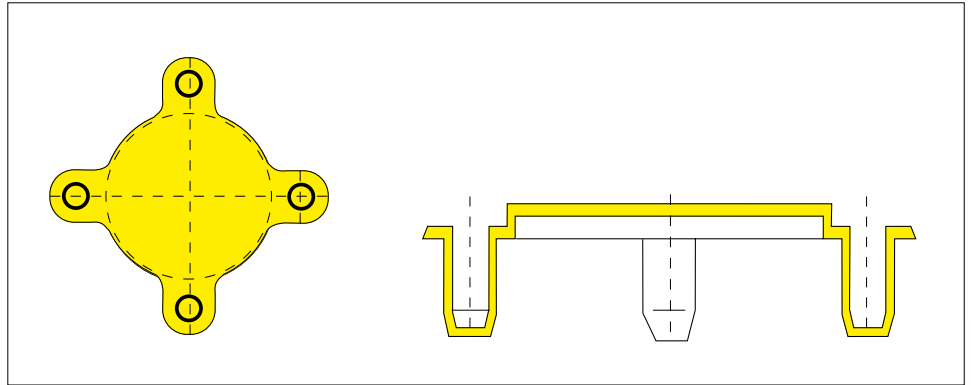

All dimensions in mm

## EN 12351-A.3 ASA/ ANSI BS 1560

**Material :**  
 LLD-PE,  
 linear low density polyethylene

**Standard Colours :**  
 blue - 150 lbs. series  
 black - 300 lbs. series

Suitable for ASA/ANSI/BS1560 flanges. Quick fitting. Simply insert plugs into the bolt holes.  
 DIN 2631-2635 flanges.

Think Plastic. Go Protec.®



Ø Flange Dimensions Nom Ø	lbs. Serie Pressure Group	Standard Pack	Reference No.
.1/2"	125, 150 lbs	800	EP 304 / .1/2" / 150
.1/2"	300, 600 lbs	800	EP 304 / .1/2" / 300
.3/4"	125, 150 lbs	800	EP 304 / .3/4" / 150
.3/4"	300, 600 lbs	500	EP 304 / .3/4" / 300
1."	125, 150 lbs	600	EP 304 / 1." / 150
1."	300, 600 lbs	400	EP 304 / 1." / 300
1.1/2"	125, 150 lbs	400	EP 304 / 1.1/2" / 150
1.1/2"	300, 600 lbs	250	EP 304 / 1.1/2" / 300
2."	125, 150 lbs	250	EP 304 / 2." / 150
2."	300, 600 lbs	200	EP 304 / 2." / 300
3."	125, 150 lbs	200	EP 304 / 3." / 150
3."	300, 600 lbs	175	EP 304 / 3." / 300
4."	125, 150 lbs	200	EP 304 / 4." / 150
4."	300 lbs	175	EP 304 / 4." / 300
6."	125, 150 lbs	125	EP 304 / 6." / 150
6."	300 lbs	125	EP 304 / 6." / 300
8."	150 lbs	100	EP 304 / 8." / 150
8."	300 lbs	100	EP 304 / 8." / 300
10."	150 lbs	60	EP 304 / 10." / 150
10."	300 lbs	60	EP 304 / 10." / 300
12."	150 lbs	40	EP 304 / 12." / 150
12."	300 lbs	30	EP 304 / 12." / 300

Should your requirements not be shown please ask for separate quotation.  
 PROTEC products and specifications are subject to improvement and change without notice.

# Stud Hole Fitting Flange Pro-Tectors

Suitable for ASA/ANSI/BS1560 flanges. Quick fitting  
Simply insert plugs into the bolt holes  
.1/2" – 150/300 lbs. to 12." – 150/300 lbs.

## TRIPLE ADVANTAGE of PROTEC CAPTOP®

**QUALITY.** Suitable for ASA/ANSI/BS1560 flanges. Quick fitting. Simply insert plugs into the bolt holes. Will not tear or crack. Weather and petroleum resistant.

**AVAILABILITY.** With over 400 million moulded components shipped from our Oststeinbek / Hamburg logistics center we provide the fastest on time delivery service to all markets and industries.

**PHILOSOPHY.** Innovative protective closures at the best price in the market.



CAPTOP®



150 lbs. series



300 lbs. series



## EN 12351-A.3 ASA/ ANSI BS 1560

**Material :**  
LLD-PE,  
linear low density polyethylene

**Standard Colours :**  
blue - 150 lbs. series  
black - 300 lbs. series

**Individual Productions :**  
On request we develop and produce individually tailored solutions next to the standard items of this range: additional dimensions, different materials and new colours

We would be pleased to advise you.

Think Plastic. Go Protec.®

**PROTEC  
PLASTICS**